

ASSEMBLY INSTRUCTIONS

1. Before you start to assemble your tree, choose a location near a wall outlet. Assemble the tree stand and place on a level surface. (see page 2)
2. Carefully insert the bottom section of the tree into the assembled stand. Make sure the pole is firmly inserted into stand and screws tightened. Then insert section 4 into section 5, section 3 into section 4, section 2 into section 3 and the tree top into section 2.
3. Allow branches to fall into place or gently pull up and out. When adjusting branches be sure that all wires are free of branch hinges.

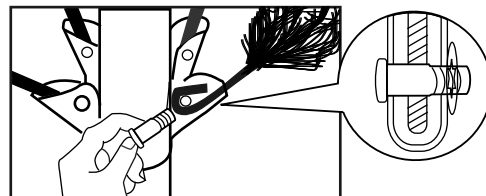

Extra staples are included for repairing the hinges. Place the branch into the slot of the bracket. Plug the staple through the holes and make sure that is fully seated.

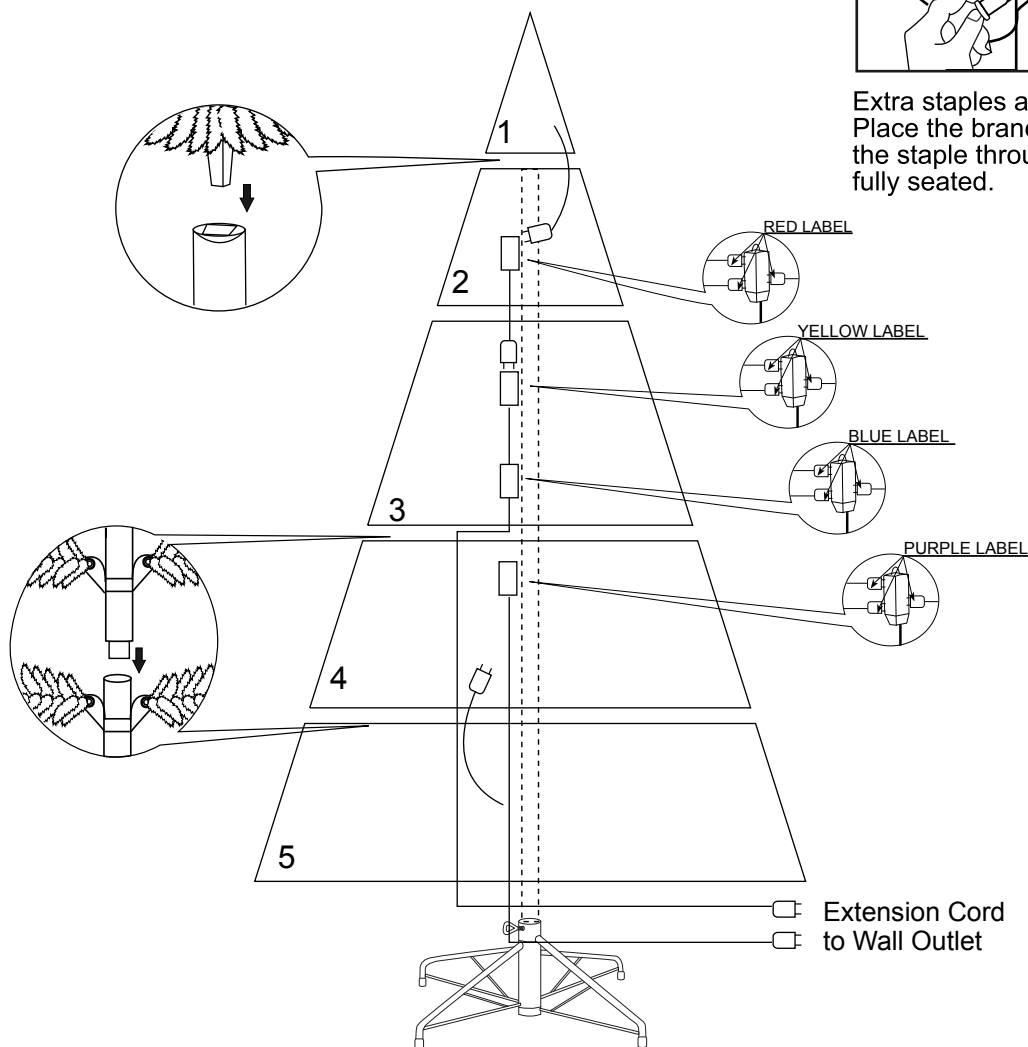

4. Connect the plug(s) securely to the extension cord(s) as shown above. Plug the extension cord into the wall outlet. Your entire tree should now be lit. If some bulbs do not light, search for any loose plugs, broken, loose or missing bulbs. Keep tree plugged in while shaping your tree. Should a light flicker while doing this, check for the bulb(s) that may have caused the trouble.
5. Begin to shape the branches working from the bottom to the top. Start with tips farthest from the pole, one to the right, one to the left and one at the center of the main stem.
6. After shaping the whole tree following the previous steps, step back and take an overall look at the tree. Shift branches to fill any gaps. Slightly upsweep all branch tips for a uniform look. Your tree is now ready to decorate and enjoy.



STAND ASSEMBLY INSTRUCTIONS

①

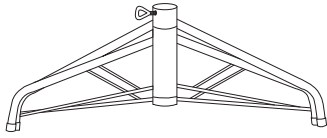

LAY THE STAND IN A FLAT AREA. THEN PULL APART THE LEGS OF THE STAND SO THAT THEY ARE X-SHAPED.

②

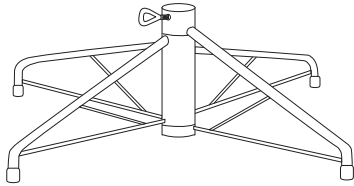

INSERT THE TREE INTO THE STAND. TIGHTEN EYE BOLT UNTIL IT TOUCHES THE TREE TRUNK WHILE KEEPING THE TREE STRAIGHT. ADJUST AS NEEDED BY LOOSENING THE EYE BOLT WHILE REPOSITIONING THE TREE TRUNK. RETIGHTEN WHEN COMPLETE.



EYE BOLT

STORAGE INSTRUCTIONS

1. Unplug extension cord from the wall outlet and remove all ornaments and decorations.
2. Unplug each section of extension cord, keeping each stack of lights connected together.
3. Gently lift of the top and middle sections, and remove the bottom section from the tree stand.
4. Carefully replace the tree in its box and tape it shut. DO NOT STORE TREE IN A DAMP AREA OR IN AN AREA WHERE THE TEMPERATURE EXCEEDS 100 DEGREES FAHRENHEIT.

CUSTOMER SERVICE FOR CHRISTMAS TREES

For any questions, comments, problems or missing part, Do Not Return to place of purchase. Please Contact Us at 1-800-530-2191 between the hours of 8am and 5pm Eastern Time Monday-Friday or visit our website at www.polygroup.com. One of our customer service representatives will be happy to assist you.

USE AND MAINTENANCE INSTRUCTIONS

1. Before using or reusing inspect product carefully. Discard any products that have cut, damaged, or frayed wire insulation or cords, cracks in the lampholders or enclosures, loose connections or exposed copper wire.
2. If you find a section that does not light, starting with the first unlit bulb, gently push (don't twist) each bulb firmly into the socket. At the same time, look and feel for a broken bulb in the socket or an empty socket where a bulb has fallen out. If a light flickers, you may have found a faulty bulb. Replace with a new bulb. (Remember to unplug the light set before replacing any bulbs)
3. If a bulb is broken, mark it with a piece of tape and unplug the tree before removing the bulb and any fragments. Replace the broken bulb.
4. If a bulb burns out, the remaining lights will stay lit. However, it is best to replace any burned out bulbs as soon as possible to prevent overheating.
5. When not in use, store neatly in a cool, dry location protected from sunlight.

FUSE REPLACEMENT INSTRUCTIONS

1. Unplug light set and remove from receptacle or other outlet device. Do not unplug by pulling on cord.
2. Open fuse cover by sliding open fuse access cover on top of attachment plug towards blades.
3. Remove fuse carefully, Turn fuseholder over and remove fuse.
4. Risk of fire: Replace fuse only with 5 Amp-125 volt fuse for the power cord set and 2 Amp-125 volt fuse for decorative lighting string (provided with product.)
5. Close fuse cover by sliding the fuse access cover on top of attachment plug.
6. Risk of fire: Do not replace attachment plug. It contains a safety device (fuse) that should not be removed. Discard product if attachment plug is damaged.

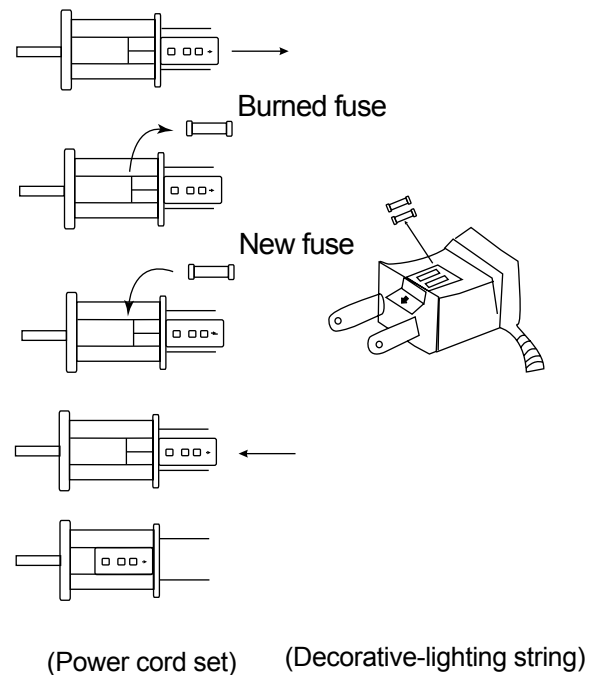

BULB REPLACEMENT INSTRUCTIONS

1. Unplug light set and remove from receptacle or other outlet device. Do not unplug by pulling on cord.
2. Lift up to unsnap locking tab (if present). Then pull bulb and plastic holder straight out of socket.
3. Replace bulb with only 2.5 volt push-in type bulb provided with product. (To reduce overheating, replace burned out bulbs promptly.)

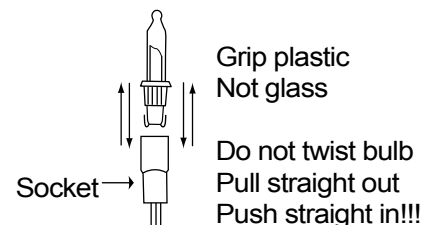

REPLACING BULB HOLDER INSTRUCTIONS

1. Bend the wires downward to release the bulb from the holder.
2. Insert the bulb into the holder.
3. Bend the wires upward.

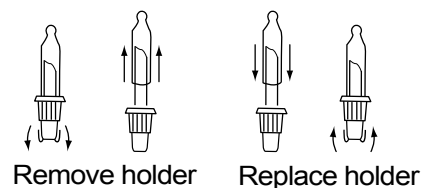

SPARE PARTS INCLUDED SAVE THESE INSTRUCTIONS

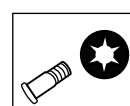

STAPLES

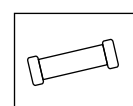

FUSE

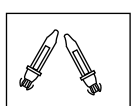

BULBS

IMPORTANT SAFETY INSTRUCTIONS

When using electrical products, basic precautions should always be followed including the following:

1. **READ AND FOLLOW ALL SAFETY INSTRUCTIONS.**
2. Do not use seasonal products outdoors unless marked suitable for indoor and outdoor use. When products are used in outdoor applications, connect the product to a Ground Fault Circuit Interrupting (GFCI) outlet. If one is not provided, contact a qualified electrician for proper installation.
3. This seasonal use product is not intended for permanent installation or use.
4. Do not mount or place near gas or electric heaters, fireplaces, candles or other similar sources of heat.
5. Do not secure the wiring of product with staples or nails, or place on sharp hooks or nails.
6. Do not let lamps rest on the supply cord or on any wire.
7. Unplug the product when leaving the house, when retiring for the night, or if left unattended.
8. This is an electric product-not a toy! To avoid risk of fire, burns, personal injury and electric shock it should not be played with or placed where small children can reach it.
9. Do not use this product for other than its intended use.
10. Do not hang ornaments or other objects from cord, wire or light string.
11. Do not close doors or windows on the product or extension cords as this may damage the wire insulation.
12. Do not cover the product with cloth, paper or any material not part of the product when in use.
13. This product has a polarized plug (one blade is wider than the other) as a feature to reduce the risk of electric shock. This plug will fit in a polarized outlet only one way. If the plug does not fit fully in the outlet, reverse the plug. If it still does not fit, contact a qualified electrician. Do not use with an extension cord unless plug can be fully inserted. Do not alter or replace the plug.
14. This product is equipped with push-in type lamps. Do not twist lamps.
15. This product employs overload protection (fuse). A blown fuse indicates an overload or short-circuit situation. If the fuse blows, unplug the product from the outlet. Also unplug any additional strings or products that may be attached to the product. Replace the fuse as per the user servicing instructions (follow product marking for proper fuse rating) and check the product. If the replacement fuse blows, a short-circuit may be present and the product should be discarded.
16. Read and follow all instructions that are on the product or provided with the product.
17. **SAVE THESE INSTRUCTIONS**