

# DISTRIBUTED BY: GP LIMITED

8/F, Enterprise Square 3, 39 Wang Chiu Road, Kowloon Bay, Hong Kong

Customer Service Representative: General Foam Plastics Corporation

(800) 813-0206 • www.GENFOAM.com

## RP TYPE SWIMMING POOL FILTER SYSTEM OWNERS MANUAL FOR ABOVE GROUND QUICK SET® SWIMMING POOLS

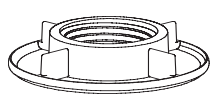

2X

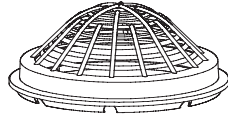

2X



2X

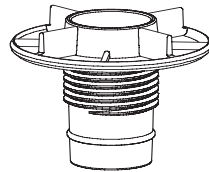

2X



2X

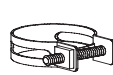
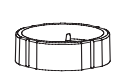
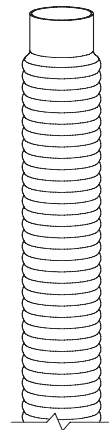
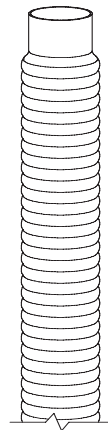

2X

4X

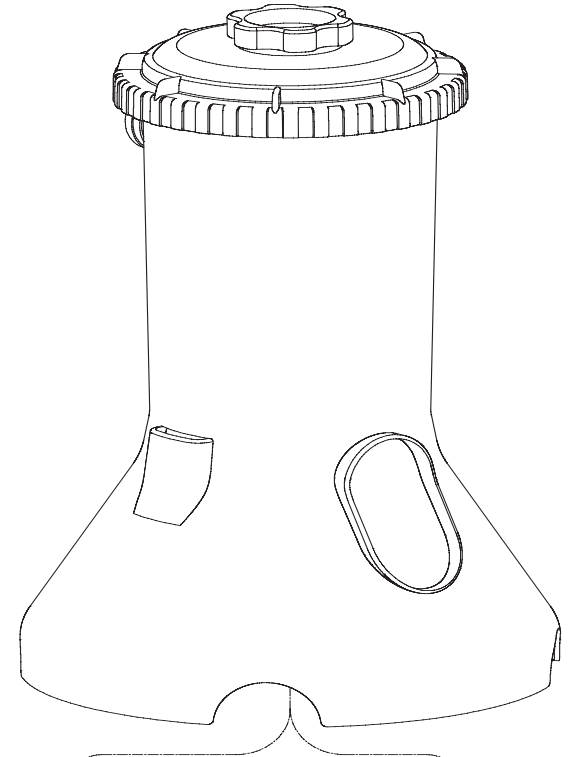
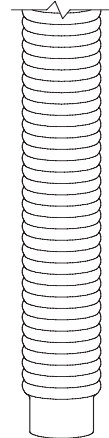
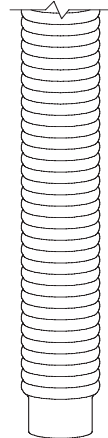

UL IMPORTANT SAFETY INSTRUCTIONS	2
PRELIMINARY STEPS	2
POWER FILTER	2
FILTER CARTRIDGE CLEANING	5
POOL MAINTENANCE	6
POOL WATER CARE	6
TROUBLE SHOOTING GUIDE	7
DISASSEMBLY AND STORAGE	7
PARTS & ACCESSORIES	8

F1000C / F1500C / F2000C

F600C & F700C

### ATTENTION CUSTOMER: STATEMENT OF LIMITED WARRANTY

GP Limited warrants to the original purchaser only, the RP Type Power Filter against defects in material and workmanship, as follows:

- 1) GP Limited warrants to the original purchaser, the RP Type Power Filter against defects in material and workmanship for 180-days from the date of purchase. Original Purchaser must retain proof of such purchase in the form of a store sales receipt and must produce such upon request by GP Limited or its customer service representative, General Foam Plastics Corporation at (800) 813-0206.
- 2) You should first consult the Trouble Shooting guide for a simple solution, page #7. If still unable to correct the situation, please contact customer service representative General Foam Plastic's customer service at (800) 813-0206. Do not return your pool or parts to the place of purchase. A knowledgeable customer service representative will assist you in resolving the problem and arrange replacement of defective parts, if needed.

If the unit is found to have been consumer damaged or abused, it is not covered by the limited warranty. If this is the case, you will be advised of the cost of replacement part(s), or the need to return damaged part(s) for warranty replacement.

2009

084-120815



# IMPORTANT SAFETY INSTRUCTIONS

When installing and using this electrical equipment, basic safety precautions should always be followed, including the following:

1. **READ AND FOLLOW ALL INSTRUCTIONS**
2. **WARNING** - To reduce the risk of injury, do not permit children to use this product unless they are closely supervised at all times by an adult who is capable of assisting a child in distress.
3. **WARNING** - Risk of electrical shock. Connect only to a grounded receptacle protected by a ground-fault circuit-interrupter (GFCI). A GFCI must be provided in accordance with Section 680-31 of the National Electrical Code. Contact a qualified electrician if you cannot verify that the receptacle is protected by GFCI.
4. **WARNING** - To reduce the risk of electrical shock, replace damaged cord (with pump body) immediately. NEVER bury cord. Locate cord to eliminate abuse or contact from lawn mowers, hedge trimmers, and other equipment. NEVER use an extension cord to connect unit to electric supply; provide a properly located outlet.
5. **CAUTION** - The power filter is for use with storable pools only. DO NOT use with permanently installed pools. A storable pool is constructed so that it may be readily disassembled for storage and reassembled to its original integrity. A permanently installed pool is constructed in or on the ground or in a building so that it cannot be readily disassembled for storage.
6. **CAUTION** - For continued protection against possible electric shock, use only original equipment manufactured (OEM) parts for your replacement requirements.
7. **SAVE THESE INSTRUCTIONS.**

## PRELIMINARY STEPS

1. **READ ALL INSTRUCTIONS CAREFULLY** and get a thorough understanding of what is required to assemble your GP Limited Type RP Power Filter.
2. Before you begin to assemble the pool, identify, count, and check all parts needed for assembly. Refer to the "PARTS LIST", Page #8, under the quantity needed column for your size pool.
3. It is recommended that you have some PETROLEUM JELLY on hand for lubricating the gaskets.

## POWER FILTER

### IMPORTANT NOTES:

1. Installer shall follow written instructions provided for operation of the circulation systems.
2. All electrical components shall be installed in accordance with Article 680 of the National Electrical Code (NEC) "Swimming Pools, Fountains and Similar Installations" or its latest approved edition.
3. The Filter Cartridge (15) 3-3/4" will hold as many as 2 of the 1" diameter chlorine tablets and the 8" will hold as many as 6 of the 1" diameter chlorine tablets. Check your chlorine levels to determine the proper number of chlorine tablets to add. The filter cartridge will automatically dispense chlorine into the pool as the pump runs. **You must have the type of Filter Cartridge (15) with a central core mesh divider (See page 3) to use the chlorine dispenser. DO NOT use this to dispense powdered chlorine, shock treatment or any other type of chemicals as damage to the pump, filter cartridge, and pool will occur.**
4. The RP Type pump/filter systems are manufactured by Dongguan Polyfilm Plastic Products Co. Ltd. and UL Listed (file #E307476) - double insulated and grounded - 115 V.A.C. - 60 Hz. (ALL Units must have a minimum of 105 V.A.C. to start and run properly.)

RP600 Filter System with F600C Pump	46 watts	0.8 amps	580 G.P.H.
RP800 Filter System with F700C Pump	57 watts	1.1 amps	780 G.P.H.
RP1000 Filter System with F1000C Pump	80 watts	2.2 amps	1075 G.P.H.
RP1000 Filter System with F1500C Pump	120 watts	2.0 amps	1500 G.P.H.
RP2000 Filter System with F2000C Pump	210 watts	2.2 amps	2000 G.P.H.

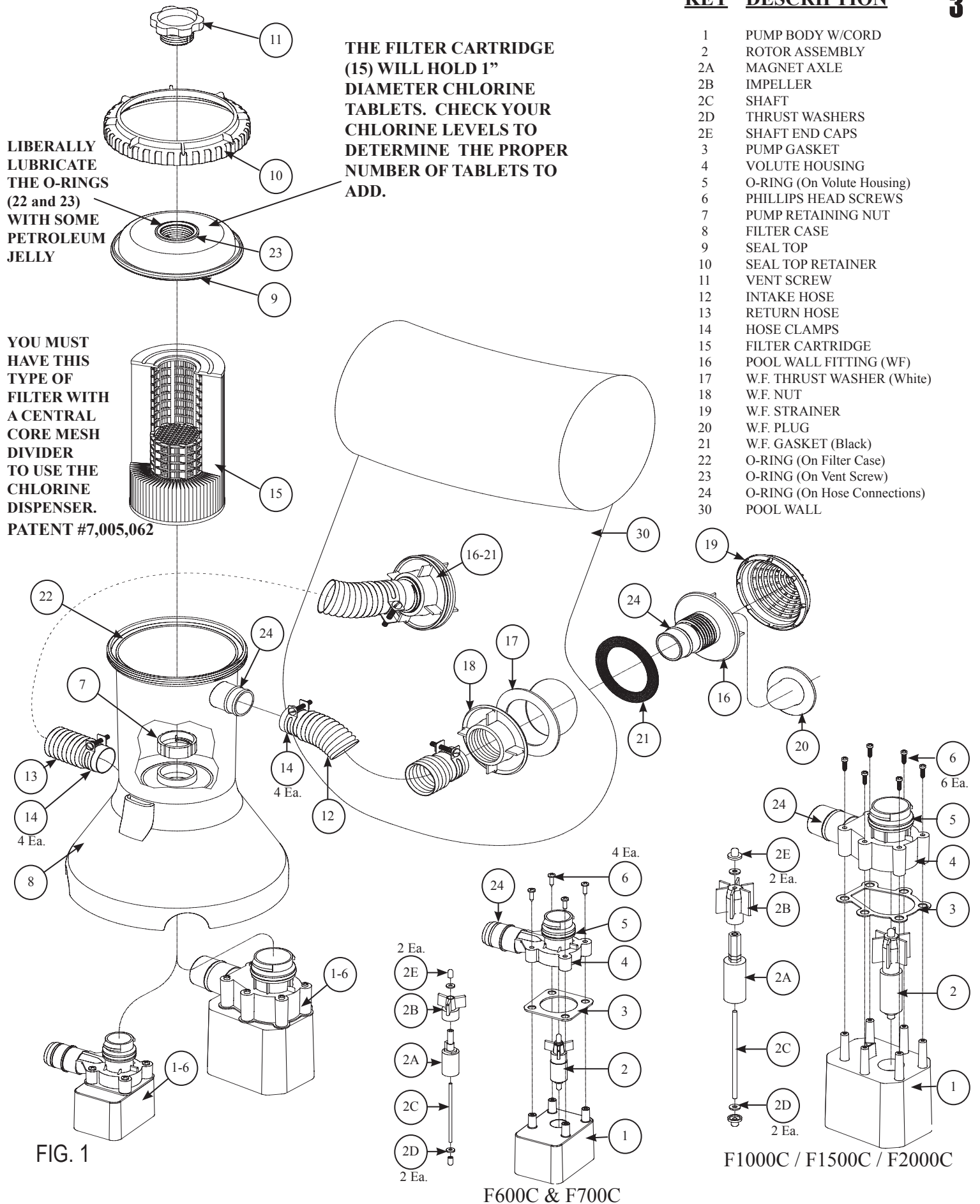

Should you encounter any problems, contact the Customer Service Representative/Parts Department at (800) 813-0206 between 8:00 a.m. and 5:00 p.m. Mon. thru Fri. Eastern Standard time

#### 4 1. POWER FILTER INSTALLATION: (Reference Page 3, Fig. 1)

### WARNING - EXTREMELY IMPORTANT!

- Risk of electrical shock, connect only to a grounding type receptacle protected by a ground fault circuit interrupter, (GFCI). Contact a qualified electrician if you cannot verify that the receptacle is protected by a GFCI.
- Receptacle must be at least 10 feet away from pool.
- Filter system can be used as many hours as desired, but **NEVER** when the pool is occupied.
- Do not use an extension cord to connect unit to electric supply; provide a properly located outlet.
- Do not bury the cord.

**NOTE** - The Power Filter will be in four sections: a pump; filter assembly; hardware bag; and intake / return hoses.

- A. First, remove the Seal Top Retainer (10), Seal Top (9), and Filter Cartridge (15) from the assembled Filter Case. Lubricate the pump O-ring (5) with petroleum jelly. Hold the Filter Case (8) securely, and insert pump assembly (1) so that the outlet on the Volute Housing (4) extends out of the opening in the side of the base. Insert the pump until it bottoms out, and the two ribs on the volute housing insert into the two slots on the bottom of the filter case. Reach down inside the filter case and place the Pump Retaining Nut (7) over the top of the volute housing inlet. Twist the Nut (7) clockwise until it is snug. See Fig. 2.
- B. Get the Intake and Return Hoses (12, 13), and remove two Hose Clamps (14), from the hardware bag. Loosen the hose clamps and slide them over one end of each hose. Lubricate O-rings (24) on the filter case. Install one hose on the filter case inlet, and one hose on the filter case outlet. Tighten both of the Hose Clamps (14).
- C. Locate both sets of Pool Wall Fitting assembly parts (16-21). Lubricate the black Wall Fitting Gasket (21) and install it over the threads on the Pool Wall Fitting (16). Insert the pool wall fitting with a gasket through one of the holes in the wall from the inside of the pool. Place the white Wall Thrust Washer (17) over the pool wall fitting and then thread the Wall Fitting Nut (18) onto the fitting until it is hand tight. **DO NOT** over tighten the wall fitting nut or wrinkle the pool wall around the Wall Fitting Thrust Washer (17) or Wall Fitting Gasket (21). Plug the Pool Wall Fitting (16) with the Wall Fitting Plug (20) from the inside of the pool. Repeat this step for other set of pool wall fittings, installing them in the other hole in the wall. Set the Wall Fitting Strainers (19) aside for later. Start filling pool.
- D. After the pool is filled, position the Filter Assembly between the two fittings on the side of the pool, about 6 inches out from the base. The intake hose (12), coming from the top of the filter case should be facing the right, and the return hose (13) coming from the pump, on the lower side of the case, should be facing the left; see Fig.3.
- E. Slip both of the remaining Hose Clamps (14) over the ends of the two hoses. Lubricate O-rings (24) on the wall fittings then connect the hoses to the intake and outlet wall fittings located on the side of the pool. The intake fitting is on the right, and the return fitting is on the left. Secure both of the hoses in place by tightening the two Hose Clamps (14).
- F. Unscrew the Vent Screw (11) from the Seal Top (9) about 1-1/2 turns. **NOTE: VENTING THE SYSTEM IS NECESSARY FOR AIR TO ESCAPE AS THE FILTER CASE FILLS WITH WATER.**
- G. Remove the two Wall Fitting Plugs (20) from the intake fitting and return fitting on the inside of the pool. This allows the filter system to fill with water. **DO NOT** discard the Wall Fitting Plugs (20) - You will need them when you change the Filter Cartridge or service the pump. When full, water should be coming out of the groove of the vent screw. Hand-tighten the vent screw into the seal top until the O-Ring seals around the screw and no more water is escaping. Now take the two Filter Intake Screens (19) and snap them over both of the Thru-the-Wall Fittings (16).
- H. At this point, the filter system should be water-tight. Check all hoses and fittings, as well as the vent screw, to
- 4** make sure there is no water leakage. If any leaks are found, see #4 in the Trouble Shooting guide on page #7.

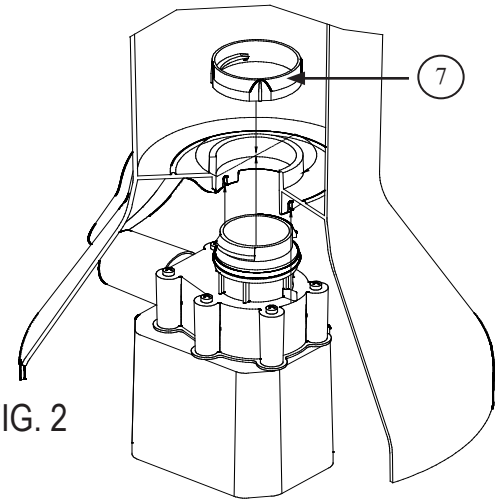

FIG. 2

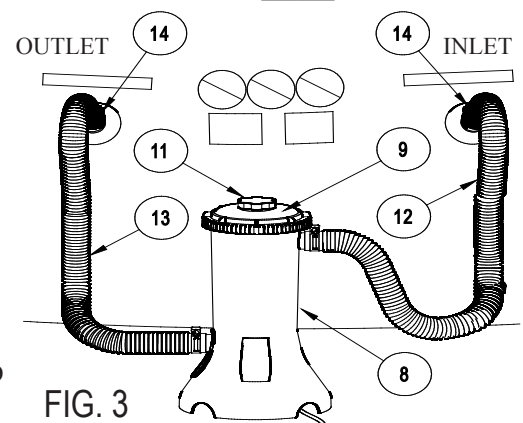

FIG. 3

## 2. PUMP OPERATION:

**IMPORTANT: FILTER CARTRIDGE MUST BE FIRMLY SEATED OVER THE PUMP INTAKE PORT TO FILTER THE POOL WATER EFFICIENTLY.**

**NOTE: ONLY FILTER CARTRIDGES WITH A 1-3/4" INCH DIAMETER HOLE WILL WORK PROPERLY. ANY OTHER SIZE HOLE WILL PREVENT PROPER FILTRATION. THE CARTRIDGE MUST SEAL TIGHTLY AROUND BOTH ENDS.**

- A. Plug filter into a properly grounded receptacle, located at least 10 feet away, protected with a ground fault circuit interrupter (GFCI).
- B. Check the return fitting on the inside of the pool for correct flow, it should feel like a solid stream of water returning to the pool. You can use the return flow as a gauge to determine when the filter needs cleaning and/or replacement. If you feel a reduction in flow, clean and/or replace filter.
- C. Test water and adjust as needed, see "POOL WATER CARE", page #6. **VERY IMPORTANT – PUMP AND FILTER ALONE WILL NOT PREVENT ALGAE FROM GROWING IN POOL WATER; THIS CAN ONLY BE DONE BY MAINTAINING PROPER CHLORINE AND pH LEVELS AT ALL TIMES!**
- D. The filter may need to be cleaned and/or replaced several times at start up until the correct chlorine and pH levels are attained. We recommend that you keep at least one spare cartridge on hand at all times. Filter cartridges may be purchased at the store you purchased your pool from, or ordered from GFP, see page #8, Item #15.

## 3. FILTER CARTRIDGE CLEANING INSTRUCTIONS:

- A. You will need to clean the Filter Cartridge. First, unplug (turn off) the Power Filter, remove both of the Wall Fitting Strainers (19) and plug both the intake and return wall fittings with Wall Fitting Plugs (20). Press the plugs squarely into the opening, to assure a leak-proof fit. To vent the filter, slowly unscrew the Vent Screw (11). Press down with both hands and twist the Seal Top Retainer (10) counter-clockwise to remove and then pull out the Seal Top (9) and Filter Cartridge (15). After you are finished cleaning the filter cartridge, liberally lubricate the O-Ring (22) with petroleum jelly and re-assemble in reverse order.
- B. The filter cartridge can be cleansed of coarse dirt and debris by pressure washing inside and out with a garden hose, making sure to wash between all pleats. Fine particles of dirt are more easily removed from the filter pleats when the cartridge is dry. Therefore, after hosing the cartridge, allow the filter to dry and CAREFULLY BRUSH, but do not scrub the pleated surface areas. Cleaning and scrubbing a filter too vigorously will also wear out the cartridge much faster than if it is simply hosed off correctly.
- C. Suntan oils, body oils, and algae can form a coating on the filter pleats which may not be thoroughly removed by hosing. Such films of oils and/or algae will rapidly clog up the filters' pores, greatly reducing filtration. Therefore, it is imperative to remove such materials from the filter element as soon as possible. To remove oils, we recommend soaking the cartridge in a solution of **1 pound of trisodium phosphate** (or any other strong detergent) **to 5 gallons of water** for up to **12 hours**. Trisodium phosphate is available in many supermarkets, hardware stores, or janitorial supply stores. After the oils have been removed, rinse the filter cartridge to remove any dirt. If algae is a problem, add **1/2 pint of pool chlorine** or **1 pint of liquid household bleach** to the cleaning solution, **1 hour** before removing the filter cartridge from the solution. Thoroughly rinse the filter cartridge before replacing it in the filter case. Check the pool chemistry to determine the cause of algae growth.
- D. Excessive calcium and/or mineral deposits may build up on a filter cartridge and should be handled differently. Contact your local pool supply store to ask about additional filter cartridge cleaners or treatment for calcium or mineral deposits. Check pool chemistry for high pH or alkalinity; this may cause a calcium or mineral build-up. Now is a good time to remove the Vent Screw (11) and put chlorine tablets into the Filter (15) if necessary..
- E. A spare "stand-by" Filter Cartridge is an excellent investment. It provides a convenient way to continue filtration of your pool while cleaning or replacing a dirty Filter Cartridge. Also, a well-maintained, clean cartridge assures you that your filter will always be ready to operate at peak efficiency.

## POOL MAINTENANCE:

1. Check and adjust pH and chlorine levels daily using required chemicals. See "POOL WATER CARE", below.
2. Check filter output daily. If flow is reduced, see Symptom 2 in "TROUBLE SHOOTING GUIDE", page #7.
3. Check filter for leaks. If a leak is found, see Symptom 4 in "TROUBLE SHOOTING GUIDE", page #7.
4. Check seams in pool periodically. Minor repairs may be made with the patch kit (supplied with pool). Additional patches are available from General Foam Plastics or your local pool supply store.

### POOL WATER CARE

1. The following items are required and readily available from your local pool supply store:
  - A. TEST KIT - Used to check chlorine and pH levels.
  - B. 1" CHLORINE TABLETS - Used to disinfect pool water and help control the growth of algae.
  - C. pH CONTROL CHEMICALS - Used to adjust pH levels Up (Soda Ash) or Down (Acid).
  - D. ALGAECIDES - Used to eliminate algae.
  - E. SUPERCHLORINATOR - Used to destroy combined chlorine, ammonia, nitrogen, and organic compounds.
  - F. LEAF NET with handle - Used to remove leaves, trash, insects, etc. from pool.
  - G. CHLORINE DISPENSER (Supplied with Filter) - Used to dispense 1" chlorine tablets ONLY.
2. Use test kit daily to check pH and chlorine levels. Adjust accordingly using the required chemicals.
 

**NOTE:** Excessive levels of chlorine or low pH levels will damage pool liner.
3. The pool can be cleaned using a garden hose powered vacuum from General Foam Plastics or a pool supply store.
4. Using a foot bath near the pool to wash off your feet prior to entering the pool will assist in keeping the pool clean.
5. Well water often presents special problems with water chemistry. If you must use well water, take a sample to your local pool chemical supplier for analysis before adding ANY chemicals.
6. Use the gallons for your pool to calculate the amount of chemicals you will need to correct the pool water based on the gallons of water in your pool. Note: It is recommended to use a 5 gallon bucket of water to mix and dissolve your chemicals and then applying directly to the pool water. Follow manufacturers label directions on all chemicals.

For your convenience, fill in your pool's information in the below chart. This info is in your pool set-up instruction manual.

POOL TYPE	FILTER/PUMP TYPE	POOL CAPACITY/GALLONS

\*Most pool supply stores will test your pool water for free and advise you of what chemicals you need, and the correct amount to use for your pool. You will need to tell them the pool capacity in gallons.

7. **IMPORTANT** - We cannot over-stress the importance of proper and adequate daily chemical treatment. Chlorine and pH levels must be maintained at all times. **PUMP AND FILTER ALONE WILL NOT PREVENT ALGAE FROM GROWING IN POOL WATER; THIS CAN ONLY BE DONE BY MAINTAINING PROPER CHLORINE AND pH LEVELS AT ALL TIMES.**
  - A. Maintain pH level between 7.3 and 7.8.
  - B. Maintain chlorine level between 1.0 and 1.6 ppm (parts per million).
  - C. Superchlorinate your pool at least every other week.

**NOTE:**

1. Hot weather/heavy use may require pH and chlorine levels to be maintained on the upper side of the scale and superchlorination of the pool every week.
2. Using a pool cover and/or solar cover will assist in maintaining your pH and chlorine levels by reducing the amount of evaporation from your pool.

**CAUTION** - Concentrated chlorine levels and low pH levels will damage pool.

**DANGER** - You must follow the instructions for the pool chemicals you use, as to quantity and recommended usage.

**NEVER** drop lumps or pellets of chemicals in pool; this may present a hazard to swimmers and/or damage your liner.

# TROUBLE SHOOTING GUIDE

DISCONNECT ELECTRICAL CORD BEFORE TROUBLESHOOTING FILTER

SYMPTOM	PROBLEM	POSSIBLE SOLUTION
<b>1</b> Motor fails to start or kicks on and off.	<b>A</b> Unit Not Plugged In	<b>A</b> Unit must be plugged into a 3-wire grounded outlet with a GFCI type circuit breaker.
	<b>B</b> GFCI Breaker Tripped	<b>B</b> Reset circuit breaker. If problem persists, have an electrician check circuit.
	<b>C</b> Low Voltage	<b>C</b> Check line voltage - must be 105 to 125 AC volts.
	<b>D</b> Rotor Jammed	<b>D</b> See the "Rotor Service" diagram in the assembly view of the Filter/Pump unit, page #3.
<b>2</b> No flow or low flow through return hose	<b>A</b> Low Water Level	<b>A</b> Water depth must be no more than 2" from the bottom of inflatable ring or it must cover the intake by at least 4".
	<b>B</b> Inlet / Discharge Clogged	<b>B</b> Check for obstructions at intake fitting and in return hose.
	<b>C</b> Filter Dirty	<b>C</b> Clean (see page #5) or replace cartridge. Spare cartridges make service more convenient.
	<b>D</b> Rotor Jammed	<b>D</b> See the "Rotor Service" diagram in the assembly view of the Filter/Pump unit, page #3.
<b>3</b> Filter is not cleaning pool (water cloudy, green, etc.)	<b>A</b> Chlorine Level	<b>A</b> Maintain chlorine level between 1.0 and 1.6 ppm
	<b>B</b> Filter Dirty	<b>B</b> Clean (see page #5) or replace cartridge. Spare cartridges make service more convenient.
	<b>C</b> pH Level	<b>C</b> Maintain pH Level between 7.3 and 7.8.
	<b>D</b> Cartridge Damaged	<b>D</b> Check cartridge for damage and/or holes. Replace if damaged.
	<b>E</b> Low Water Flow	<b>E</b> Check for obstructions at intake fitting and in return hose fitting.
	<b>F</b> Other Chemicals Required	<b>F</b> Have water tested at pool supply store. It may be necessary to add other chemicals due to varying water quality in different localities.
	<b>G</b> Pool Water Very Dirty	<b>G</b> Run pump more often, but never when pool is in use. Clean filter more often.
<b>4</b> Water Leakage	<b>A</b> Intake Hose / Return Hose (4) connection points	<b>A</b> Adjust hose clamp (14) on cuff. Check O-ring (24) and retighten. Check hose for any holes or cracks. Replace if needed. See page #3.
	<b>B</b> Vent Screw in Seal Top	<b>B</b> Check O-ring (23) for damage. Replace if needed. Lubricate with petroleum jelly.
	<b>C</b> Seal Top Retainer/Seal Top	<b>C</b> Check O-ring (22) for damage. Replace if needed. Lubricate with petroleum jelly.
	<b>D</b> Pump to Volute Housing	<b>D</b> Tighten screws (6). Check Pump Gasket (3) for damage. Replace if needed. See page #3.
	<b>E</b> Volute Housing to Filter	<b>E</b> Check Volute Housing O-Ring (5) for damage. Replace if needed. See page #3.
	<b>PROBLEMS: Call GFP Corp. Parts Dept. at 1-800-813-0206 between 8 a.m. and 5 p.m. Mon. thru Fri. Eastern Standard Time.</b>	

## POWER FILTER DISASSEMBLY AND STORAGE

- A. First, unplug the Power Filter. Now remove both of the Wall Fitting Strainers (19), and then plug both of the Pool Wall Fittings (16) with the two Wall Fitting Plugs (20).
- B. Slowly unscrew the Vent Screw (11) from the Seal Top (9) allowing the filter system to depressurize.
- C. Remove the Seal Top Retainer (10) by turning counter-clockwise to unscrew. Remove the Seal Top (9). Remove the Filter Cartridge (15) and remove any chlorine tablets left inside the core section of the filter.
- D. Loosen all four Hose Clamps (14), remove the Intake and Return Hoses (12, 13) and allow water to drain out.
- E. Remove both sets of Pool Wall Fitting components (16-21) from the side wall of the pool. Clean and dry all the parts and re-assemble them to keep all the parts together. DO NOT re-install the parts through the holes in the pool wall.
- F. Clean and dry all filter pump parts including filter cartridges.
- G. Liberally lubricate the O-rings (22), at the Seal Top (9) and (23) on the Vent Screw (11), with petroleum jelly, and then reassemble it along with the Seal Top (9), Seal Top Retainer (10), Vent Screw (11) onto the Filter Case (8). Store all filter parts carefully.

---

Should you encounter any problems, contact the Customer Service Representative/Parts Department at (800) 813-0206 between 8:00 a.m. and 5:00 p.m. Mon. thru Fri. Eastern Standard time

## RP FILTER SYSTEM PARTS LIST

KEY	DESCRIPTION	RP600 / F600C		RP800 / F700C		RP1000 / F1000C		RP1000 / F1500C		RP2000 / F2000C		QTY	LBS
		ID NUMBER	COST	ID NUMBER	COST	ID NUMBER	COST	ID NUMBER	COST	ID NUMBER	COST		
1	PUMP BODY WITH CORD	096-050136	20.00	096-050406	30.00	096-050504	35.00	096-050504	35.00	096-050564	45.00	1	4
2	ROTOR ASSEMBLY	096-050137	8.00	096-110003	10.00	096-050505	15.00	096-050598	20.00	096-050565	25.00	1	1/2
3	PUMP GASKET	078-110186	1.00	078-110031	1.50	078-110078	2.50	078-110078	2.50	078-110078	2.50	1	1/4
4	VOLUTE HOUSING	078-110187	1.50	078-110189	3.00	078-110097	5.00	078-110097	5.00	078-110147	7.00	1	1/4
5	O-RING (On Volute Housing)	090-130012	1.25	090-130012	1.25	090-130012	1.25	090-130012	1.25	090-130025	1.50	1	1/4
6	PHILLIPS HEAD SCREW ( 6 EA)	090-010063	.75	090-010063	.75	090-010063	.75	090-010063	.75	090-010063	.75	1	1/4
*	ASSEMBLED PUMP #1 THRU #6	096-050138	30.00	096-050086	45.00	096-050091	50.00	096-050599	55.00	096-050118	75.00	1	5
7	PUMP RETAINING NUT	078-110110	1.50	078-110110	1.50	078-110110	1.50	078-110110	1.50	078-110143	1.50	1	1/4
8	FILTER CASE	078-110188	15.00	078-110100	15.00	078-110114	15.00	078-110114	15.00	078-110139	25.00	1	2
9	SEAL TOP	078-110101	6.00	078-110101	6.00	078-110101	6.00	078-110101	6.00	078-110140	8.00	1	1
10	SEAL TOP RETAINER	078-110102	4.00	078-110102	4.00	078-110102	4.00	078-110102	4.00	078-110102	4.00	1	1
11	VENT SCREW	078-110103	2.00	078-110103	2.00	078-110103	2.00	078-110103	2.00	078-110103	2.00	1	1/4
12	INTAKE HOSE 3 FT.	063-060032	3.50	063-060010	3.50	063-060010	3.50	063-060010	3.50	063-060010	3.50	1	1
13	RETURN HOSE 3 FT.	063-060032	3.50	063-060010	3.50	063-060010	3.50	063-060010	3.50	063-060010	3.50	1	1
14	HOSE CLAMP	090-160009	.25	090-160005	.25	090-160005	.25	090-160005	.25	090-160005	.25	4	1/2
15	3-3/4" FILTER CARTRIDGE 2 SQ. FT.	090-050140	5.00	N/A	---	N/A	---	N/A	---	N/A	---	1	1
*	8" FILTER CARTRIDGE 7 SQ. FT.	N/A	---	090-130011	10.00	090-130011	10.00	090-130011	10.00	090-130011	10.00	1	1
16	POOL WALL FITTING	078-110198	3.00	078-110122	3.00	078-110122	3.00	078-110122	3.00	078-110122	3.00	2	1/2
17	WALL FITTING THRU ST WASHER	078-110199	1.25	078-110124	1.25	078-110124	1.25	078-110124	1.25	078-110124	1.25	2	1/4
18	WALL FITTING NUT	078-110200	1.75	078-110125	1.75	078-110125	1.75	078-110125	1.75	078-110125	1.75	2	1/4
19	WALL FITTING STRAINER	078-110280	2.50	078-110067	2.50	078-110067	2.50	078-110067	2.50	078-110067	2.50	2	1/4
20	WALL FITTING PLUG	078-110126	2.00	078-110126	2.00	078-110126	2.00	078-110126	2.00	078-110126	2.00	2	1/2
21	WALL FITTING GASKET	078-110202	1.50	078-110123	1.50	078-110123	1.50	078-110123	1.50	078-110123	1.50	2	1/4
22	O-RING (On Filter Case)	090-130022	2.00	090-130022	2.00	090-130022	2.00	090-130022	2.00	090-130022	2.00	1	1/4
23	O-RING (On Vent Screw)	090-130021	1.50	090-130021	1.50	090-130021	1.50	090-130021	1.50	090-130021	1.50	1	1/4
24	O-RING (On Hose Connections)	090-130029	1.50	090-130030	1.50	090-130030	1.50	090-130030	1.50	090-130030	1.50	4	1/4
25	INSTRUCTION MANUAL	084-120815	2.00	084-120815	2.00	084-120815	2.00	084-120815	2.00	084-120815	2.00	1	1/2
26	PATCH KIT	090-250002	2.00	090-250002	2.00	090-250002	2.00	090-250002	2.00	090-250002	2.00	1	1/4
*	ASSEMBLED FILTER #1 THRU #25	096-050139	60.00	096-050547	80.00	096-050548	90.00	096-050597	95.00	096-050116	125.00	1	8